

### Application

- It is applicable to household water supply, equipment support, pipeline pressurization, garden watering, vegetable greenhouse watering, fish farming and poultry raising, industrial and mining, water supply and drainage of enterprises and high-rise buildings, central air conditioner and centralized heating circulation system, etc

### Pump

- AISI 304 shaft
- Max. liquid temperature: +85°C
- Altitude: up to 1000 m
- Max. suction: 8 m
- Max. inlet pressure: limited by max. operating pressure
- Max. operating pressure: 10 bar
- Liquid PH Value: 4-10

### Motor

- IE2 motor (IE3 motor available on request)
- Motor with copper winding
- Built-in thermal protector for single phase motor
- Insulation class: F
- Enclosures class: IP55
- Max. ambient temperature: +40°C

### Identification Codes

#### EDH (m) 2 - 30

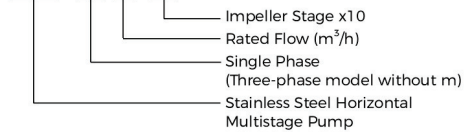

### Material Table

No.	Part	Material
1	Pump body	AISI 304
2	Support	ZL 102
3	Bottom plate	Q235
4	Stator	
5	Rotor	
6	Bearing	
7	Rear cover	ZL 102
8	Fan	PP
9	Fan cover	08F
10	Bracket cover	AISI 304
11	Mechanical seal	Sic/Carbon
12	Positioning sleeve	AISI 304
13	Diffuser 3	AISI 304
14	Diffuser 2	AISI 304
15	Sleeve	AISI 304
16	Impeller	AISI 304
17	Diffuser 1	AISI 304
18	Pressure plate	AISI 304
19	Spacer bush	AISI 304

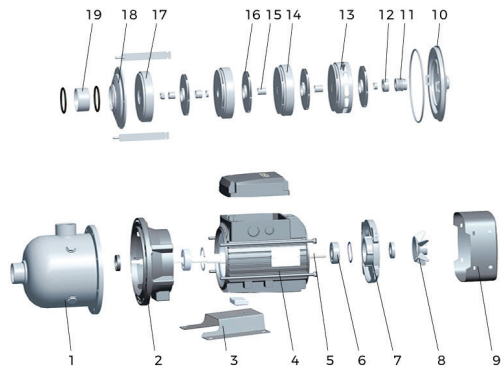

### Application

- It is applicable to household water supply, equipment support, pipeline pressurization, garden watering, vegetable greenhouse watering, fish farming and poultry raising, supply and drainage of enterprises and high-rise buildings, central air conditioner and centralized heating circulation system, etc.

### Pump

- AISI304 shaft
- Max. liquid temperature: +60°C
- Altitude: up to 1000 m
- Max. suction: 8 m
- Max. inlet pressure: limited by max. operating pressure
- Max. operating pressure: 10 bar
- Liquid PH value: 6.5 - 8.5

### Motor

- Motor with copper winding
- Built-in thermal protector for single phase motor
- Insulation class: F
- Enclosures class: IPX4
- Max. ambient temperature: +40°C

### Identification Codes

#### EDH (m) 2 - 20 - F

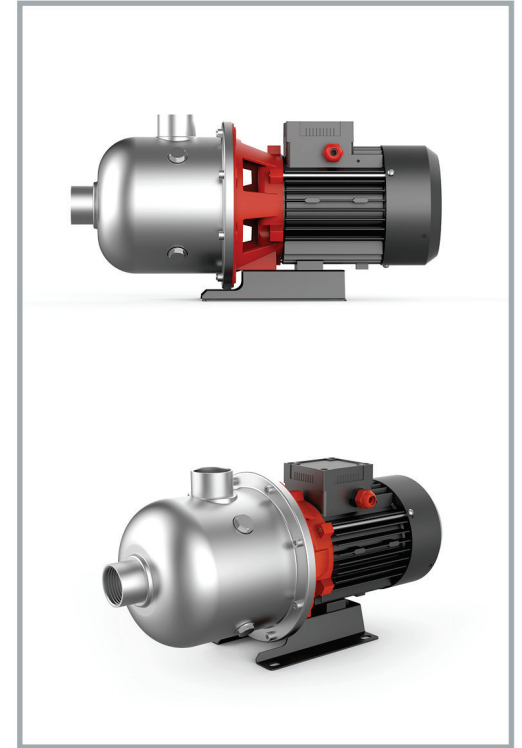
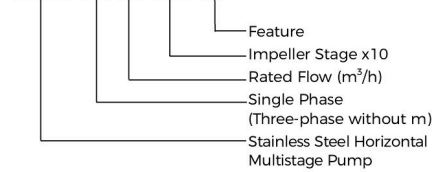

### Material Table

No.	Part	Material
1	Support	ZL 102
2	Base	Q235
3	Stator	
4	Bearing	
5	Rotor	
6	Rear	ZL 102
7	Fan	PP
8	Fan cover	08F
9	Pump body	AISI 304
10	Spacer bush	AISI 304
11	Pressure plate	AISI 304
12	Diffuser1	AISI 304
13	Tension plate	AISI 304
14	Impeller	AISI 304
15	Sleeve	AISI 304
16	Diffuser2	AISI 304
17	Diffuser3	AISI 304
18	Mechanical seal	Sic/Carbon
19	Bracket cover	AISI 304
20	Terminal cover	Plastic

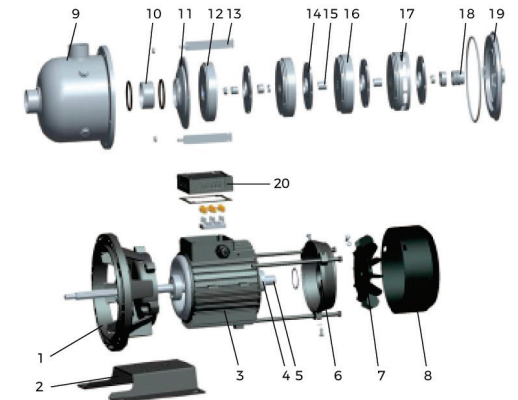

# EDH

Stainless Steel Horizontal Multistage Pump



## Scope of Performance - EDH

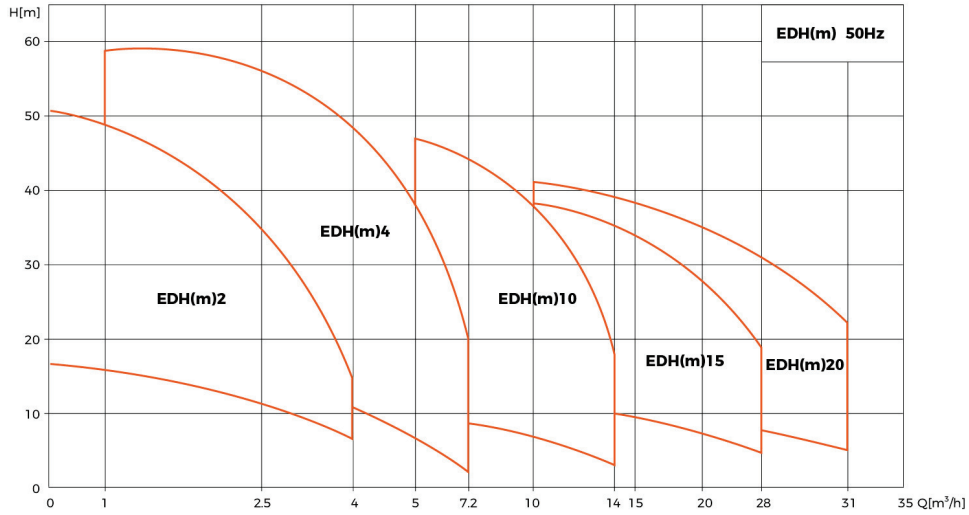

## Scope of Performance - EDH-F

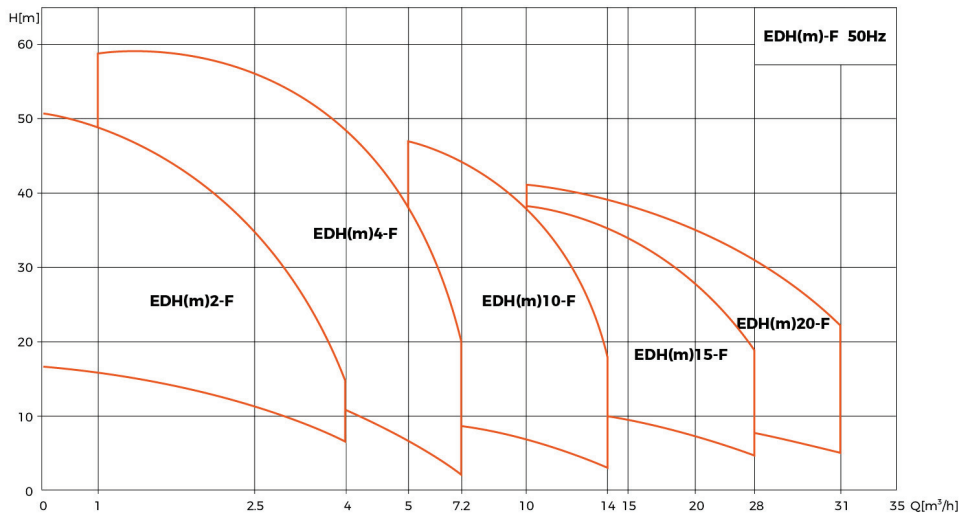

## Hydraulic Performance Curves

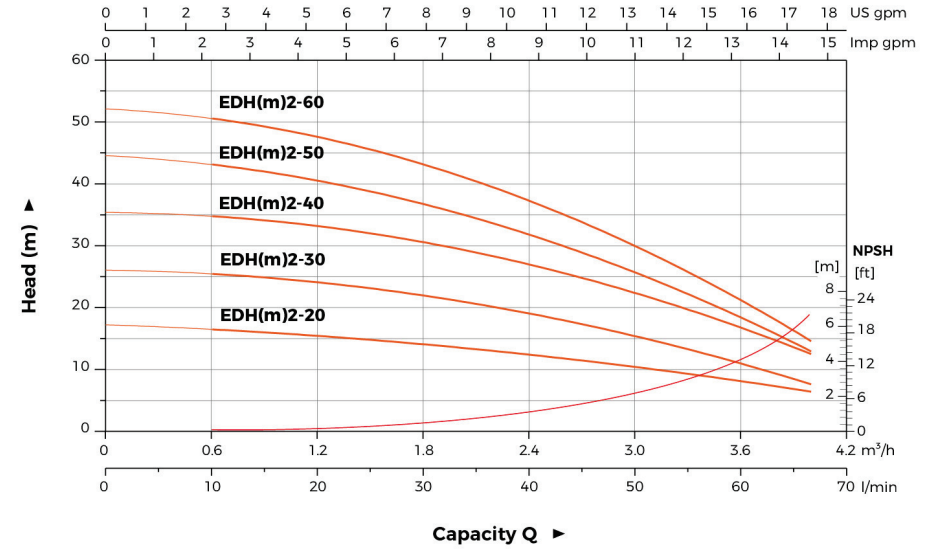

## Technical Data

Model	Power		Q(m³/h) Q(l/min)	0.5	1	1.5	2	2.5	3	3.5	4
	kW	HP		H (m)							
EDH(m)2-20	0.37	0.5	8.3	16.7	16.2	15	14	11	10.6	8.8	6.5
EDH(m)2-30	0.37	0.5	10	25.8	24.3	23.8	21.3	17	16.1	12.5	7.2
EDH(m)2-40	0.55	0.75	13.3	34.8	34.1	33.2	30.7	23	22.9	18.4	12.6
EDH(m)2-50	0.55	0.75	17.8	43.5	42.1	39.5	35.9	29	25.7	19.6	13.5
EDH(m)2-60	0.75	1.0	23.3	50.8	49.2	45.6	41.5	35	30.4	23.4	14.3

## Dimension

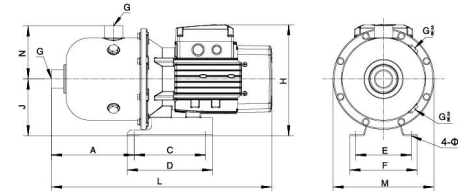

Model	L	A	C	D	E	F	G	H	J	M	N	d	CW (Kgs)	L x W x H (mm)	Quantity (PCS/20' TEU)
EDH(m)2-20	427	160	138	165	108	130	G1	216	110	Φ195	103	9	10.7	465x225x270	1044
EDH(m)2-30	427	160	138	165	108	130	G1	216	110	Φ195	103	9	11.1	465x225x270	1044
EDH(m)2-40	427	160	138	165	108	130	G1	216	110	Φ195	103	9	12.4	465x225x270	1044
EDH(m)2-50	427	160	138	165	108	130	G1	216	110	Φ195	103	9	12.8	465x225x270	1044
EDH(m)2-60	427	160	138	165	108	130	G1	216	110	Φ195	103	9	13.8	465x225x270	1044

### Hydraulic Performance Curves

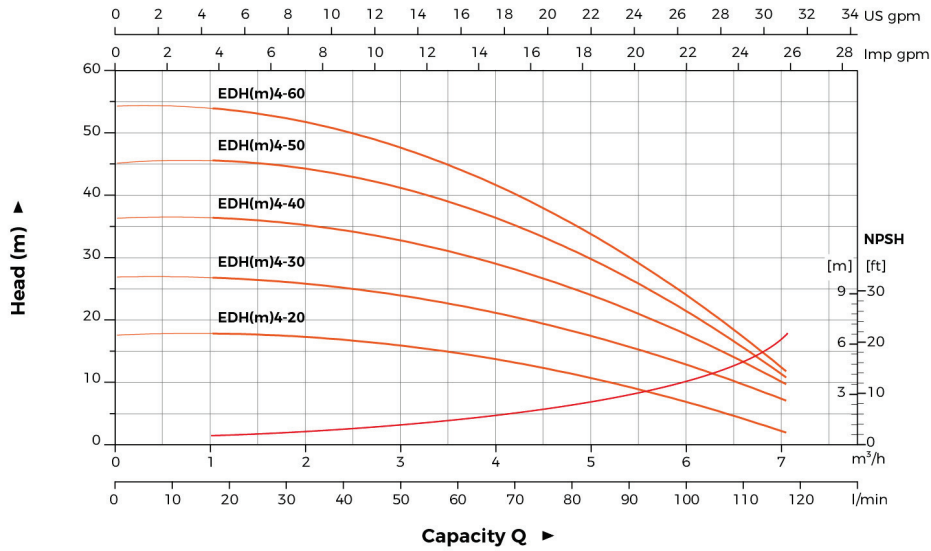

### Technical Data

Model	Power		Q(m³/h) Q(l/min)	1	2	3	4	4.5	5	6	7
	kW	HP		H (m)	17	33	50	67	75	83	100
EDH(m)4-20	0.55	0.75	H (m)	17.8	17.2	16.1	14.3	12	11.3	6.3	2.3
EDH(m)4-30	0.55	0.75		26.7	26.4	24.6	22.1	18	16.8	13.5	7.3
EDH(m)4-40	0.75	1.0		36.1	35.2	32.9	29.9	25	24.7	18.6	9.2
EDH(m)4-50	1.1	1.5		45.7	43.6	40.5	37	32	31.8	21.8	10
EDH(m)4-60	1.1	1.5		53.6	52	47	42.5	37	35	23	12

### Dimension

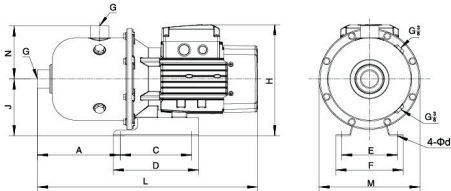

Model	L	A	C	D	E	F	G	H	J	M	N	d	GW (Kgs)	L x W x H (mm)	Quantity (PCS/20' TEU)
EDH(m)4-20	427	160	138	165	108	130	G1 1/4	216	110	Φ195	103	9	11.5	465x225x270	1044
EDH(m)4-30	427	160	138	165	108	130	G1 1/4	216	110	Φ195	103	9	12.9	465x225x270	1044
EDH(m)4-40	427	160	138	165	108	130	G1 1/4	216	110	Φ195	103	9	13.8	465x225x270	1044
EDH(m)4-50	480	160	138	165	108	130	G1 1/4	245	120	Φ195	103	9	18.2	515x225x297	870
EDH(m)4-60	480	160	138	165	108	130	G1 1/4	245	120	Φ195	103	9	18.6	515x225x297	870

### Hydraulic Performance Curves

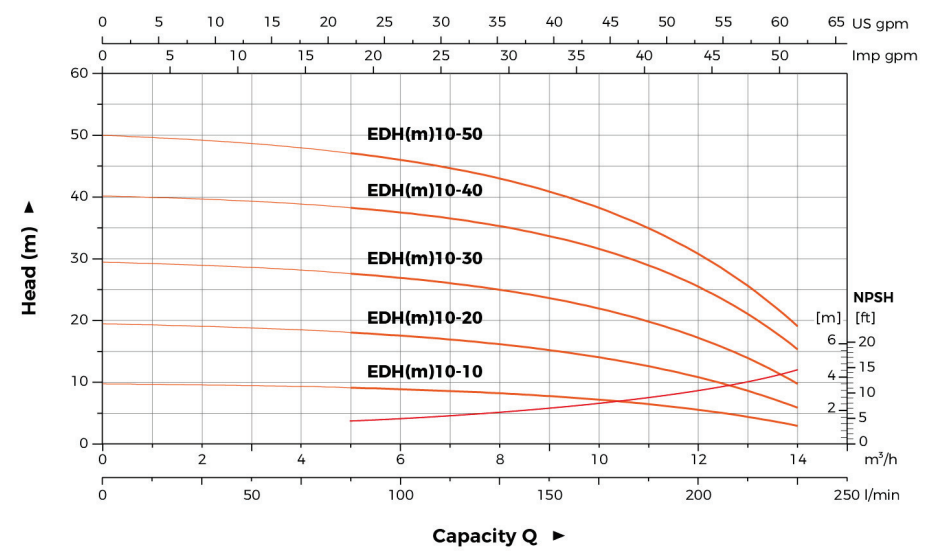

### Technical Data

Model	Power		Q(m³/h) Q(l/min)	6	7	8	9	10	11	12	13	14
	kW	HP		H (m)	100	117	133	150	167	183	200	217
EDH(m)10-10	0.75	1.0	H (m)	9.1	8.7	8.3	7.8	7.1	6.4	5.4	4.4	3.1
EDH(m)10-20	0.75	1.0		17.9	17.1	16.3	15.3	13.9	12.4	10.7	8.4	6.2
EDH(m)10-30	1.1	1.5		27.5	26.5	25.2	23.6	21.7	19.3	17	14	10
EDH(m)10-40	1.5	2.0		38.7	37.2	35.9	33.9	31.6	28.7	24.9	19.7	15.9
EDH(m)10-50	2.2	3.0		47.2	45.4	43.6	41	38.2	34.2	30	24.5	18

### Dimension

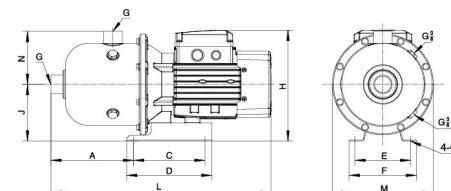

Model	L	A	C	D	E	F	G	H	J	M	N	d	GW (Kgs)	L x W x H (mm)	Quantity (PCS/20' TEU)
EDH(m)10-10	568	277	138	165	108	130	G2	245	120	Φ233	140	9	21.5	610x265x317	540
EDH(m)10-20	568	277	138	165	108	130	G2	245	120	Φ233	140	9	22	610x265x317	540
EDH(m)10-30	568	277	138	165	108	130	G2	245	120	Φ233	140	9	23	610x265x317	540
EDH(m)10-40	626	285.5	138	165	108	130	G2	248	120	Φ233	140	9	29	660x265x317	480
EDH(m)10-50	626	285.5	138	165	108	130	G2	248	120	Φ233	140	9	30.7	660x265x317	480

### Hydraulic Performance Curves

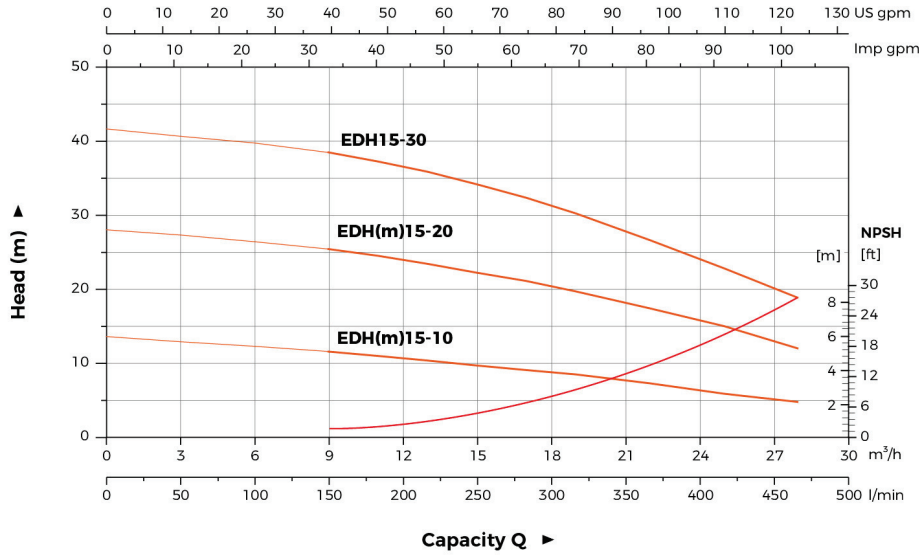

### Technical Data

Model	Power		Q(m³/h) Q(l/min)	9	11	13	15	17	19	22	25	28
	kW	HP		H (m)	150	183	217	250	283	317	367	417
EDH(m)15-10	1.1	1.5	H (m)	11.6	11	10.4	9.7	9.1	8.5	7.7	5.9	4.8
EDH(m)15-20	2.2	3.0		25.4	24.5	23.4	22.2	21.1	19.7	17.4	15	12
EDH15-30	3.0	4.0		38.4	37.2	35.8	34.1	32.3	30.2	26.6	22.8	18.8

### Dimension

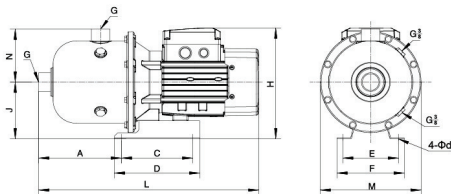

Model	L	A	C	D	E	F	G	H	J	M	N	d	GW (Kgs)	L x W x H (mm)	Quantity (PCS/20 TEU)
EDH(m)15-10	568	277	138	165	108	130	G2	245	120	Φ233	140	9	20.5	610x265x317	540
EDH(m)15-20	626	285.5	138	165	108	130	G2	248	120	Φ233	140	9	28.8	660x265x317	480
EDH15-30	626	285.5	138	165	108	130	G2	248	120	Φ233	140	9	33	660x265x317	480

### Hydraulic Performance Curves

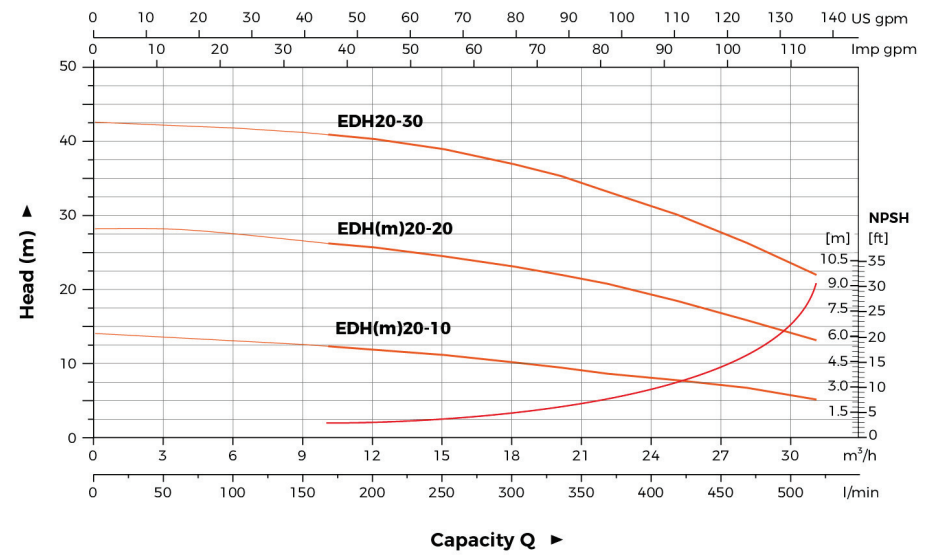

### Technical Data

Model	Power		Q(m³/h) Q(l/min)	9	12	15	18	20	22	25	28	31
	kW	HP		H (m)	150	200	250	300	333	367	417	467
EDH(m)20-10	1.1	1.5	H (m)	12.6	11.9	11.2	10.2	9.8	8.7	8	6.8	5.2
EDH(m)20-20	2.2	3.0		26.5	25.7	24.5	23.1	22	20.8	18.5	15.9	13.2
EDH20-30	4.0	5.5		41.2	40.3	38.9	36.9	35.3	33.2	30.1	26.3	22

### Dimension

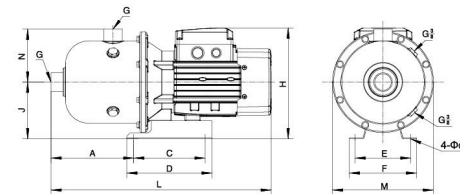

Model	L	A	C	D	E	F	G	H	J	M	N	d	GW (Kgs)	L x W x H (mm)	Quantity (PCS/20 TEU)
EDH(m)20-10	568	277	138	165	108	130	G2	245	120	Φ233	140	9	20.5	610x265x317	540
EDH(m)20-20	626	285.5	138	165	108	130	G2	248	120	Φ233	140	9	28.8	660x265x317	480
EDH20-30	642	283	140	175	190	230	G2	240	120	Φ233	140	12	37.5	675x265x317	480

### Hydraulic Performance Curves

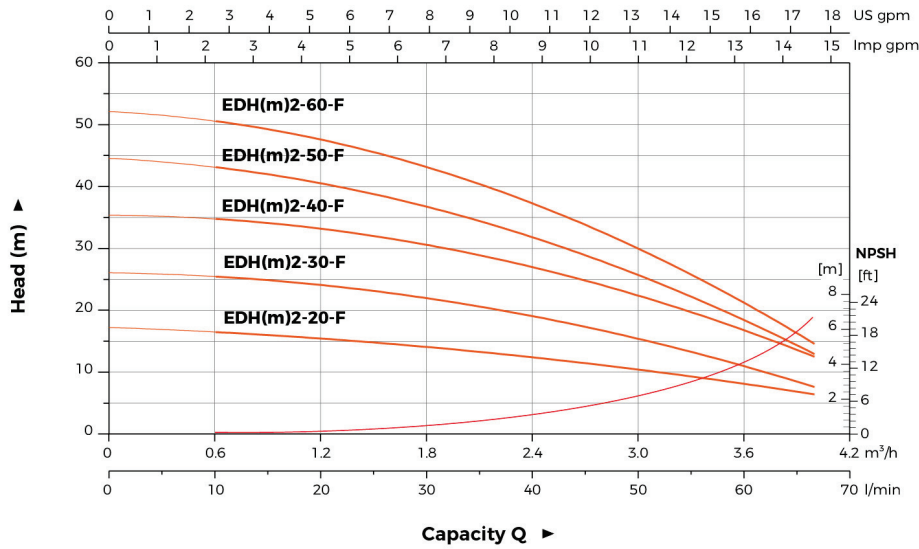

### Technical Data

Model	Power		Q(m³/h) Q(l/min)	0.5	1	1.5	2	2.5	3	3.5	4
	kW	HP		8.3	16.7	25	33.3	41.7	50	58.3	66.7
EDH(m)2-20-F	0.37	0.5	H (m)	16.7	16.2	15	14	12	10.6	8.8	6.5
EDH(m)2-30-F	0.37	0.5		25.7	24.3	23.8	21.3	19	16.1	12.5	7.2
EDH(m)2-40-F	0.55	0.75		34.9	34.1	33.2	30.7	23	22.9	18.4	12.6
EDH(m)2-50-F	0.55	0.75		43.5	42.1	39.5	35.9	29	25.7	19.6	13.5
EDH(m)2-60-F	0.75	1.0		50.8	49.2	45.6	41.5	35	30.4	23.4	14.3

### Dimension

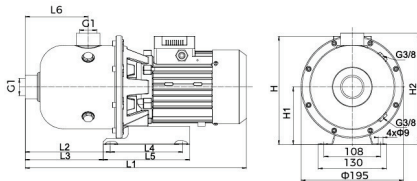

Model	L1	L2	L3	L4	L5	L6	H		H1	H2	GW (Kgs)	L x W x H (mm)	Quantity (PCS/20' TEU)
							1-	3-					
EDH(m)2-20-F	426	162	148.5	138	165	120	197.5	187	110	213	10.7	460x225x275	1044
EDH(m)2-30-F	426	162	148.5	138	165	120	197.5	187	110	213	11.1	460x225x275	1044
EDH(m)2-40-F	426	162	148.5	138	165	120	197.5	187	110	213	12.4	460x225x275	1044
EDH(m)2-50-F	426	162	148.5	138	165	120	197.5	187	110	213	12.8	460x225x275	1044
EDH(m)2-60-F	426	162	148.5	138	165	120	197.5	187	110	213	13.8	460x225x275	1044

### Hydraulic Performance Curves

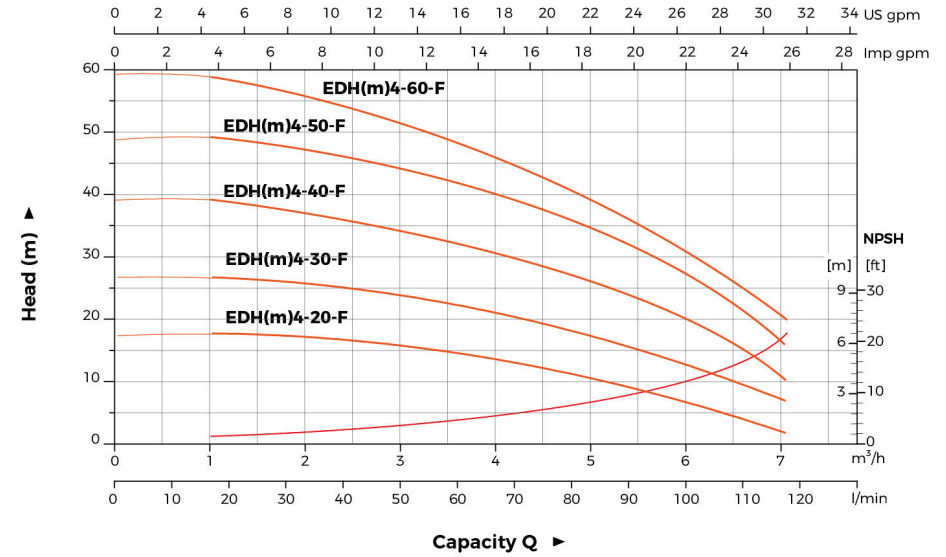

### Technical Data

Model	Power		Q(m³/h) Q(l/min)	1	2	3	4	4.5	5	6	7
	kW	HP		17	33	50	67	75	83	100	117
EDH(m)4-20-F	0.55	0.75	H (m)	17.8	17.2	16.1	14.3	12	11.3	6.3	2.3
EDH(m)4-30-F	0.55	0.75		26.7	26.4	24.6	22.1	18	16.8	13.5	7.3
EDH(m)4-40-F	0.75	1.0		39	37	34	31.5	29	27	20	11
EDH(m)4-50-F	1.1	1.5		49	47	44	41	37	35	27	17
EDH(m)4-60-F	1.1	1.5		59	55	52	47	43	39	29	20

### Dimension

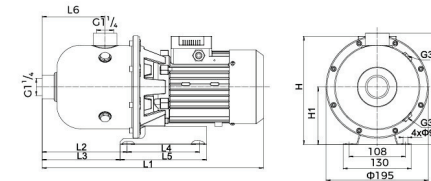

Model	L	L2	L3	L4	L5	L6	H		H1	H2	GW (Kgs)	L x W x H (mm)	Quantity (PCS/20' TEU)
							1-	3-					
EDH(m)4-20-F	429	165	151.5	138	165	123	197.5	187	110	215.5	11.5	460x225x275	1044
EDH(m)4-30-F	429	165	151.5	138	165	123	197.5	187	110	215.5	12.9	460x225x275	1044
EDH(m)4-40-F	429	165	151.5	138	165	123	197.5	187	110	215.5	13.8	460x225x275	1044
EDH(m)4-50-F	429	165	151.5	138	165	123	197.5	187	110	215.5	18.2	460x225x275	1044
EDH(m)4-60-F	429	165	151.5	138	165	123	197.5	187	110	215.5	18.6	460x225x275	1044

### Hydraulic Performance Curves

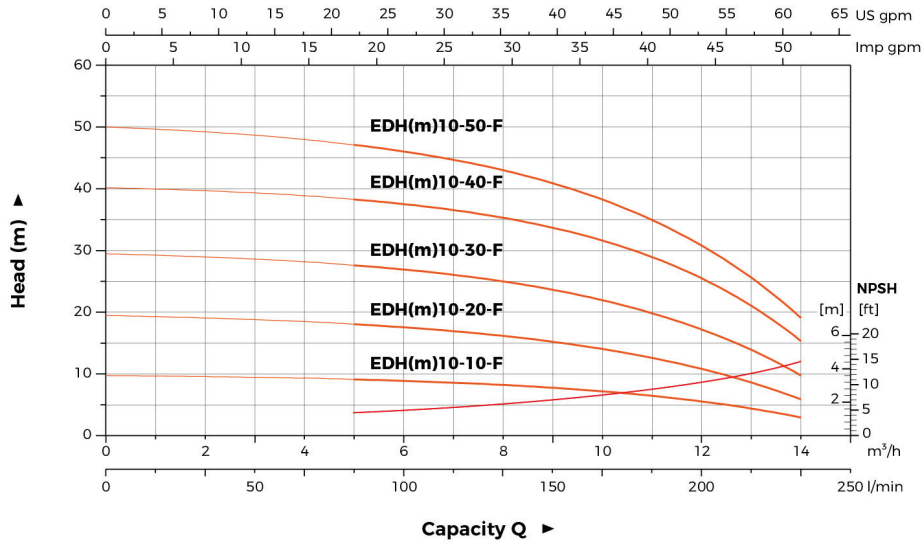

### Technical Data

Model	Power		Q(m³/h) Q(l/min)	5	7	8	9	10	11	12	13	14
	kW	HP		83	117	133	150	167	183	200	217	233
EDH(m)10-10-F	0.75	1.0	H (m)	9.1	8.7	8.3	7.8	7	6.4	5.4	4.4	3.1
EDH(m)10-20-F	0.75	1.0		17.9	17.1	16.3	15.3	13.5	12.4	10.7	8.4	6.2
EDH(m)10-30-F	1.1	1.5		27.5	26.5	25.2	23.6	21.5	19.3	17	14	10
EDH(m)10-40-F	1.5	2.0		38.7	37.2	35.9	33.9	31.5	28.7	24.9	19.7	15.9
EDH(m)10-50-F	2.2	3.0		47.2	45.4	43.6	41	38	34.2	30	24.5	18

### Dimension

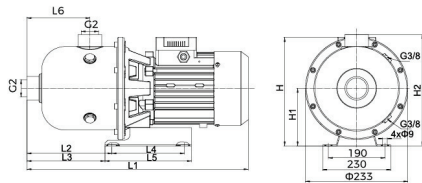

Model	L1	L2	L3	L4	L5	L6	H		H1	H2	GW (Kgs)	L x W x H (mm)	Quantity (PCS/20'2EU)
							1-	3-					
EDH(m)10-10-F	557	288	273	140	170	188	232.5	226	120	260	21.5	610x265x317	540
EDH(m)10-20-F	557	288	273	140	170	188	232.5	226	120	260	22.0	610x265x317	540
EDH(m)10-30-F	557	288	273	140	170	188	232.5	226	120	260	23.0	610x265x317	540
EDH(m)10-40-F	600	288	273	140	170	188	236	230	120	260	29.0	660x265x317	480
EDH(m)10-50-F	600	288	273	140	170	188	242	230	120	260	30.7	660x265x317	480

### Hydraulic Performance Curves

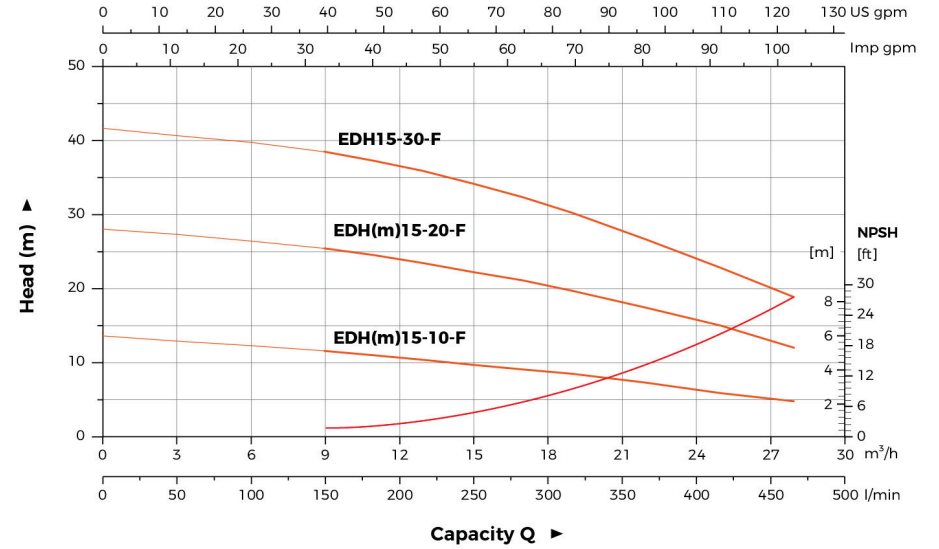

### Technical Data

Model	Power		Q(m³/h) Q(l/min)	9	11	13	15	17	19	22	25	28
	kW	HP		150	183	217	250	283	317	367	417	467
EDH(m)15-10-F	1.1	1.5	H (m)	11.6	11	10.4	9.5	9.1	8.5	7.7	5.9	4.8
EDH(m)15-20-F	2.2	3.0		25.4	24.5	23.4	22	21.1	19.7	17.4	15	12
EDH15-30-F	3.0	4.0		38.4	37.2	35.8	34	32.3	30.2	26.6	22.8	18.8

### Dimension

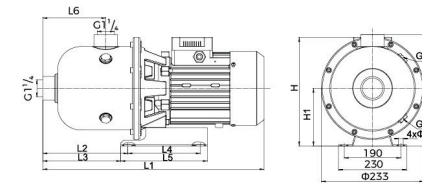

Model	L1	L2	L3	L4	L5	L6	H		H1	H2	GW (Kgs)	L x W x H (mm)	Quantity (PCS/20'2EU)
							1-	3-					
EDH(m)15-10-F	557	288	273	140	170	188	232.5	226	120	260	20.5	610x265x317	540
EDH(m)15-20-F	600	288	273	140	170	188	242	230	120	260	28.8	660x265x317	480
EDH15-30-F	620	288	273	140	170	188	250	250	120	260	33	660x265x317	480

# EDH

## Stainless Steel Horizontal Multistage Pump

### Hydraulic Performance Curves

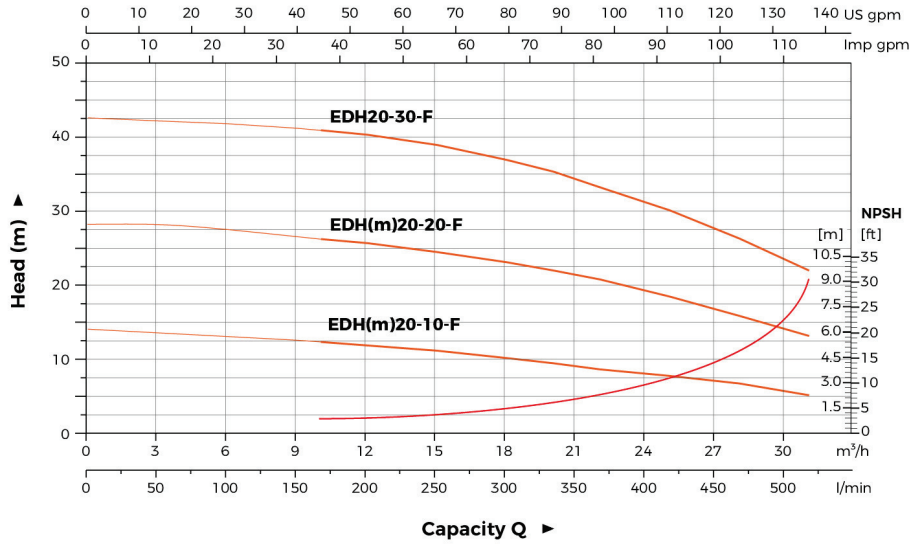

### Technical Data

Model	Power		Q(m³/h) Q(l/min)	9	12	15	18	20	22	25	28	31
	kW	HP		150	200	250	300	333	367	417	467	517
EDH(m)20-10-F	1.1	1.5	H (m)	12.4	11.9	11.2	10.2	9.5	8.7	8	6.8	5.2
EDH(m)20-20-F	2.2	3.0		26.5	25.7	24.5	23.1	22	20.8	18.5	15.9	13.2
EDH20-30-F	4.0	5.5		41.2	40.3	38.9	36.9	35	33.2	30.1	26.3	22

### Dimension

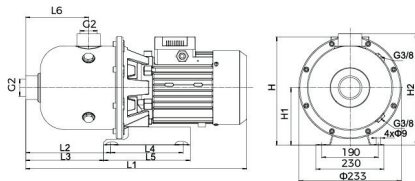

Model	L1	L2	L3	L4	L5	L6	H		H1	H2	GW (Kgs)	L x W x H (mm)	Quantity (PCS/20' TEU)
							1~	3~					
EDH(m)20-10-F	557	288	273	140	170	188	232.5	226	120	260	20.5	610x265x317	540
EDH(m)20-20-F	600	288	273	140	170	188	242	230	120	260	28.8	660x265x317	480
EDH20-30-F	620	288	273	140	170	188	250	250	120	260	37.5	675x265x317	480

# EMH

## Stainless Steel Horizontal Multistage Pump



### Application

- It is applicable to household water supply, equipment support, pipeline pressurization, garden watering, vegetable greenhouse watering, fish farming and poultry raising, industrial and mining, water supply and drainage of enterprises and high-rise buildings, central air conditioner and centralized heating circulation system, etc.

### Pump

- AISI304 welding shaft
- Max. liquid temperature: +60°C
- Altitude: up to 1000 m
- Max. inlet pressure: limited by Max. operating pressure
- Max. operating pressure: 8 bar
- Liquid PH Value: 6.5 - 8.5

### Motor

- Motor with copper winding
- Built-in thermal protector for single phase motor
- Insulation class: F
- Enclosures class: IP55
- Max. ambient temperature: +40°C

### Identification Codes

EMH (m) 8 - 3 \ 1

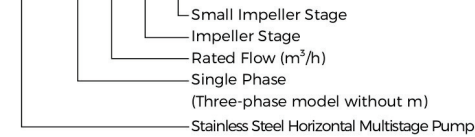

### Material Table

No.	Part	Material
1	Pump cover	ADC 12
2	Pump body	AISI 304
3	Diffuser 1	AISI 304
4	Base	Q235 Steel
5	Diffuser 2	AISI 304
6	Impeller	AISI 304
7	Sleeve	AISI 304
8	Diffuser 3	AISI 304
9	Mechanical seal	SIC/Carbon
10	O-Ring	NBR
11	Bracket cover	AISI 304
12	Bracket	ADC 12
13	Rotor	
14	Terminal Box	
15	Stator	
16	Bearing	
17	Rear cover	ADC 12
18	Fan	PP
19	Fan cover	PP

