



( Hose coupling as standard.  
Flange elbow is optional. )

**Application**

- Drainage of wastewater from the attenuation tank, purifying tank and sewage tank in water treatment plant
- Drainage of waste water containing fibrous additives from leather factory and food processing factory
- Sewage management, accumulated water, septic tank, stock farm
- Pumping sewage form hotels, restaurants, schools and public buildings

**Pump**

- Open vortex impeller, suitable for liquid containing impurities and long fiber substance
- Flexible installations with hoses, pipes or quick-coupling systems
- Float switch as standard accessory for single phase (≤1.1 kw)
- Cable Length: 10m
- Double-end mechanical seal
- Stainless steel welded shaft
- Liquid temperature: 0 - 40 °C
- Liquid PH value: 4 - 10
- Max. immersion depth: 10 m

**Motor**

- Frequency/Pole number: 50 Hz/2
- Insulation class: F
- Enclosures class: IP68
- Bearing: Ball type

**Identification Codes**

**50 SW U m 9 - 6 - 0.55 L**

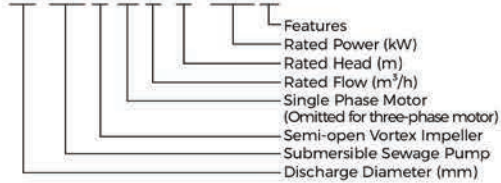

**Technical Data**

Model		Discharge	Power		Rated flow	Max. flow	Rated head	Max. head	Max. Solid Dia
Single Phase	Three Phase	mm (inch)	kW	HP	m³/h	m³/h	m	m	mm
50SWUm9-6-0.55L	50SWU9-6-0.55L	50 (2")	0.55	0.75	9	19	6	9.5	35
50SWUm13.2-4-0.55L	50SWU13.2-4-0.55L	50 (2")	0.55	0.75	13	22	4	6	50
50SWUm12-8-0.75L	50SWU12-8-0.75L	50 (2")	0.75	1	12	22.5	8	13	35
50SWUm15-5.5-0.75L	50SWU15-5.5-0.75L	50 (2")	0.75	1	15	27	5.5	9	50

**Dimension**

Model	L1 (mm)	L2 (mm)	L3 (mm)	L4 (mm)	H (mm)	H1 (mm)	D (mm)	D1 (mm)	D2 (mm)	M (mm)
50SWU(m)9-6-0.55L	195	160	80	121	483	64	35	110	14	14
50SWU(m)13.2-4-0.55L	201	166	86		508	79	50			
50SWU(m)12-8-0.75L	195	160	80		483	64	35			
50SWU(m)15-5.5-0.75L	201	166	86		508	79	50			

**Hydraulic Performance Curves**

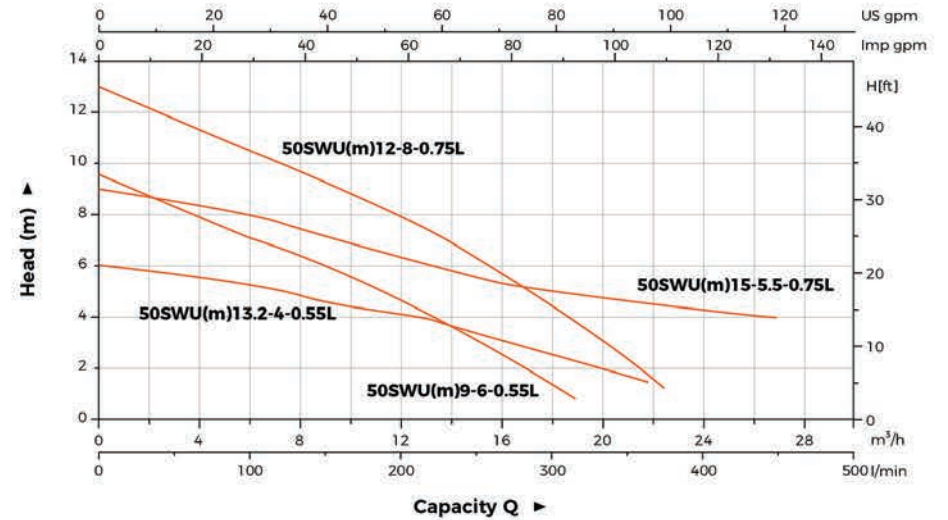

**Material Table**

No.	Part	Material
1	Handle	ZG45
2	Upper cover	HT200
3	Upper bearing seat	HT200
4	Motor body	HT200
5	Oil chamber	HT200
6	Pump cover	HT200
7	Pump body	HT200
8	Impeller	HT200
9	Oil seal	
10	Mechanical seal	Upper:SiC/Carbon Lower:SiC/SiC
11	Bearing	
12	Rotor	
13	Stator	

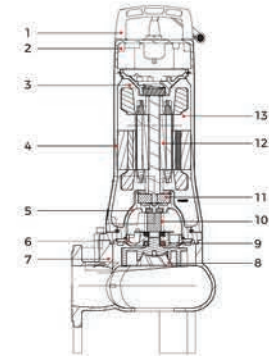

**Package Information**

Model	GW (kg)		L (mm)	W (mm)	H (mm)	Quantity (PCS/20'TEU)
	1-	3-				
50SWU(m)9-6-0.55L	24.6	23.9	746	254	286	544
50SWU(m)13.2-4-0.55L	25.1	24.3	746	254	286	544
50SWU(m)12-8-0.75L	25.9	25.2	746	254	286	544
50SWU(m)15-5.5-0.75L	26.4	25.6	746	254	286	544



**Application**

- Drainage of wastewater from the attenuation tank, purifying tank and sewage tank in water treatment plant
- Drainage of waste water containing fibrous additives from leather factory and food processing factory
- Sewage management, accumulated water, septic tank, stock farm
- Pumping sewage form hotels, restaurants, schools and public buildings

**Pump**

- Open vortex impeller, suitable for liquid containing impurities and long fiber substance
- Flexible installations with hoses, pipes or quick-coupling systems
- Double-end mechanical seal
- Stainless steel welded shaft
- Liquid temperature: 0 - 40 °C
- Liquid PH value: 4 - 10
- Max. immersion depth: 10 m

**Motor**

- Frequency/Pole number: 50 Hz/2
- Insulation class: F
- Enclosures class: IP68
- Bearing: Ball type

**Identification Codes**

**65 SW U m 24 - 8.5 - 1.5 L**

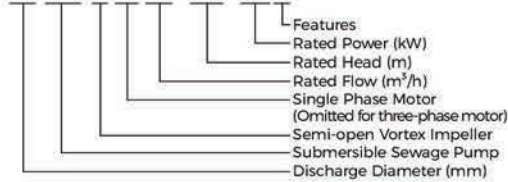

**Technical Data**

Model		Discharge	Power		Rated flow	Max. flow	Rated head	Max. head	Max. Solid Dia
Single Phase	Three Phase	mm (inch)	KW	HP	m³/h	m³/h	m	m	mm
65SWUm24-8.5-1.5L	65SWU24-8.5-1.5L	65 (2.5")	1.5	2	24	38	8.5	13	55
65SWUm24-12.5-2.2L	65SWU24-12.5-2.2L	65 (2.5")	2.2	3	24	40	12.5	17	55
-	65SWU30-11-3L	65 (2.5")	3	4	30	46	11	18	55
-	65SWU30-16-4L	65 (2.5")	4	5.5	30	54	16	24	55

**Dimension**

Model	L1 (mm)	L2 (mm)	L3 (mm)	L4 (mm)	H (mm)		H1 (mm)	D (mm)	D1 (mm)	D2 (mm)	M (mm)
					1-	3-					
65SWU(m)24-8.5-1.5L	266	218	110	167	483	590	91	65	130	14	16
65SWU(m)24-12.5-2.2L					508	590					
65SWU30-11-3L					-	621					
65SWU30-16-4L					-	621					

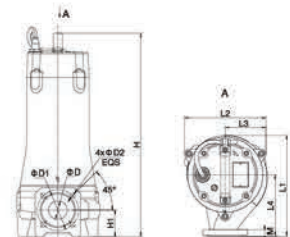

**Hydraulic Performance Curves**

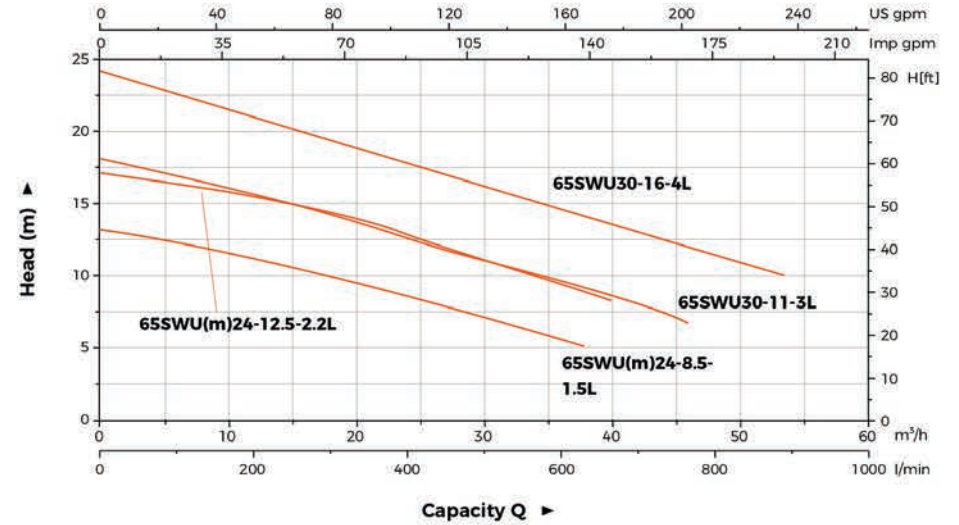

**Material Table**

No.	Part	Material
1	Handle	ZG45
2	Upper cover	HT200
3	Upper bearing seat	HT200
4	Motor body	HT200
5	Oil chamber	HT200
6	Pump cover	HT200
7	Pump body	HT200
8	Impeller	HT200
9	Oil seal	
10	Mechanical seal	Upper:SiC/Carbon Lower:SiC/SiC
11	Bearing	
12	Rotor	
13	Stator	

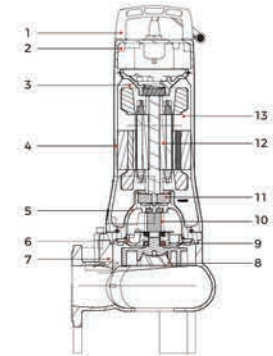

**Package Information**

Model	GW (kg)		L (mm)	W (mm)	H (mm)	Quantity (PCS/20' TEU)
	1-	3-				
65SWU(m)24-8.5-1.5L	48.8	45	924	284	363	294
65SWU(m)24-12.5-2.2L	49	47.2	924	284	363	294
65SWU30-11-3L	-	54.5	874	284	363	316
65SWU30-16-4L	-	56.7	874	284	363	316



**Impeller**

**Application**

- Drainage of wastewater from the attenuation tank, purifying tank and sewage tank in water treatment plant
- Drainage of waste water containing fibrous additives from leather factory and food processing factory
- Sewage management, accumulated water, septic tank, stock farm
- Pumping sewage form hotels, restaurants, schools and public buildings

**Pump**

- Open vortex impeller, suitable for liquid containing impurities and long fiber substance
- Flexible installations with hoses, pipes or quick-coupling systems
- Double-end mechanical seal
- Stainless steel welded shaft
- Liquid temperature: 0 - 40 °C
- Liquid PH value: 4 - 10
- Max. immersion depth: 10 m

**Motor**

- Frequency/Pole number: 50 Hz/2
- Insulation class: F
- Enclosures class: IP68
- Bearing: Ball type

**Identification Codes**

**80 SW U m 30 - 4.5 - 1.5 L**

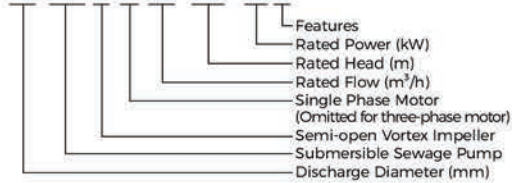

**Technical Data**

Model		Discharge	Power		Rated flow	Max. flow	Rated head	Max. head	Max. Solid Dia
Single Phase	Three Phase	mm (inch)	kW	HP	m <sup>3</sup> /h	m <sup>3</sup> /h	m	m	mm
80SWUm30-4.5-1.5L	80SWU30-4.5-1.5L	80(3")	1.5	2	30	50	4.5	6	76
80SWUm30-7-2.2L	80SWU30-7-2.2L	80(3")	2.2	3	30	45	7	8	76

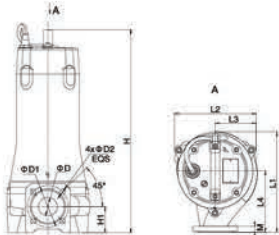

**Dimension**

Model	L1	L2	L3	L4	H (mm)		H1	D	D1	D2	M
	(mm)	(mm)	(mm)	(mm)	1-	3-	(mm)	(mm)	(mm)	(mm)	(mm)
80SWU(m)30-4.5-1.5L	260	224	118	149	672	631	122	75	150	18	18
80SWU(m)30-7-2.2L											

**Hydraulic Performance Curves**

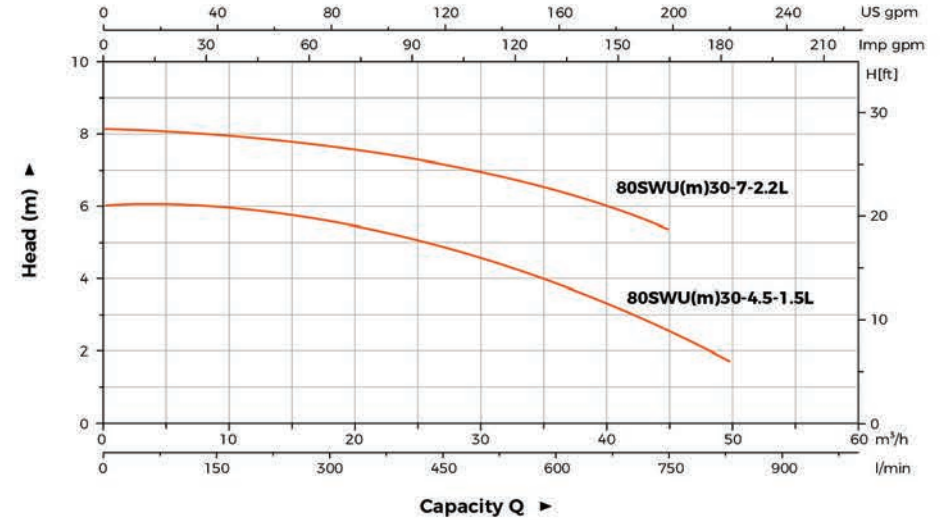

**Material Table**

No.	Part	Material
1	Handle	ZG45
2	Upper cover	HT200
3	Upper bearing seat	HT200
4	Motor body	HT200
5	Oil chamber	HT200
6	Pump cover	HT200
7	Pump body	HT200
8	Impeller	HT200
9	Oil seal	
10	Mechanical seal	Upper:SiC/Carbon Lower:SiC/SiC
11	Bearing	
12	Rotor	
13	Stator	

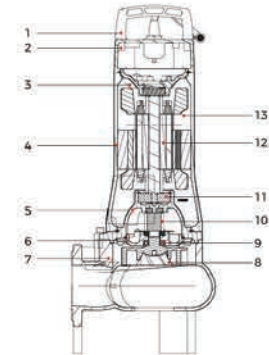

**Package Information**

Model	GW (kg)		L (mm)	W (mm)	H (mm)	Quantity (PCS/20'TEU)
	1-	3-				
80SWU(m)30-4.5-1.5L	49.1	45.4	924	284	363	294
80SWU(m)30-7-2.2L	49.4	47.5	924	284	363	294