



**Application**

- Drainage of wastewater from the attenuation tank, purifying tank and sewage tank in water treatment plant
- Drainage of waste water containing fibrous additives from leather factory and food processing factory
- Sewage management, accumulated water, septic tank, stock farm
- Pumping sewage form hotels, restaurants, schools and public buildings

**Pump**

- High-efficiency & anti-clogging enclosed channel impeller
- Flexible installations with hoses, pipes or quick-coupling systems
- Float switch as standard accessory for single phase (≤1.1kW)
- Cable Length: 10m
- Double-end mechanical seal
- Stainless steel welded shaft
- Liquid temperature: 0 - 40 °C
- Liquid PH value: 4 - 10
- Max. immersion depth: 10 m

**Motor**

- Frequency/Pole number: 50 Hz/2
- Insulation class: F
- Enclosures class: IP68
- Bearing: Ball type

**Identification Codes**

**50 SWE m 8 - 16 - 1.1 L**

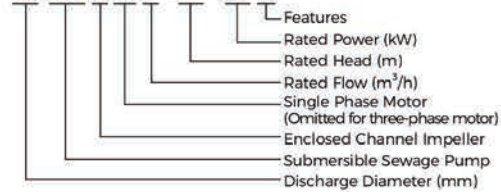

**Technical Data**

Model		Discharge	Power		Rated flow	Max. flow	Rated head	Max. head	Max. Solid Dia
Single Phase	Three Phase	mm (inch)	KW	HP	m³/h	m³/h	m	m	mm
50SWE m 6-12-0.55L	50SWE6-12-0.55L	50 (2")	0.55	0.75	6	19	12	15	20
50SWE m 6-16-0.75L	50SWE6-16-0.75L	50 (2")	0.75	1	6	22	16	19	20
50SWE m 10-10-0.75L	50SWE10-10-0.75L	50 (2")	0.75	1	10	20	10	15	20
50SWE m 8-16-1.1L	50SWE8-16-1.1L	50 (2")	1.1	1.5	8	26	16	19	15
50SWE m 8-20-1.5L	50SWE8-20-1.5L	50 (2")	1.5	2	8	25	20	22	15
50SWE m 15-20-2.2L	50SWE15-20-2.2L	50 (2")	2.2	3	15	45	20	23	25
-	50SWE15-25-3L	50 (2")	3	4	15	51	25	27	25

**Dimension**

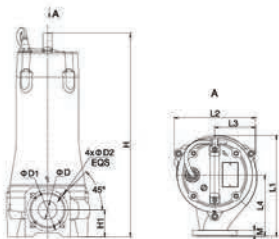

Model	L1 (mm)	L2 (mm)	L3 (mm)	L4 (mm)	H (mm)		H1 (mm)	D (mm)	D1 (mm)	D2 (mm)	M (mm)
					1-	3-					
50SWE(m)6-12-0.55L	212				461	461		45			14
50SWE(m)6-16-0.75L		184		120	479	479	65				
50SWE(m)10-10-0.75L	210		96		570	529		47	110	14	
50SWE(m)8-16-1.1L	223			135	571	530	70	50			16
50SWE(m)8-20-1.5L	227				-	561					
50SWE(m)15-20-2.2L	268	221	112	163							
50SWE15-25-3L											

**Hydraulic Performance Curves**

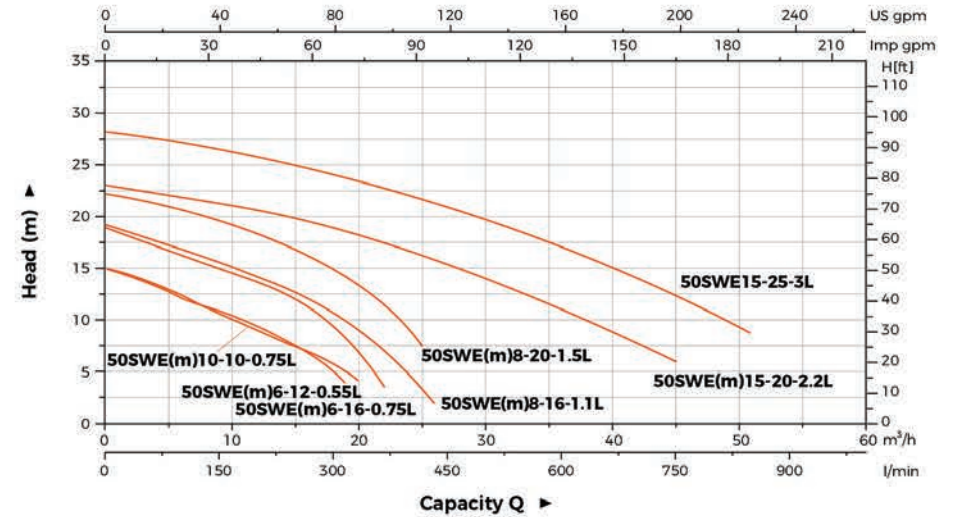

**Material Table**

No.	Part	Material
1	Handle	ZC45
2	Upper cover	HT200
3	Upper bearing seat	HT200
4	Motor body	HT200
5	Oil chamber	HT200
6	Pump cover	HT200
7	Pump body	HT200
8	Impeller	HT200
9	Oil seal	
10	Mechanical seal	Upper:SiC/Carbon Lower:SiC/SiC
11	Bearing	
12	Rotor	
13	Stator	

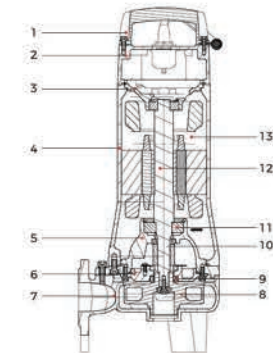

**Package Information**

Model	GW (kg)		L (mm)	W (mm)	H (mm)	Quantity (PCS/20'TEU)
	1-	3-				
50SWE(m)6-12-0.55L	24.7	24	746	254	286	544
50SWE(m)6-16-0.75L	26	25.3	746	254	286	544
50SWE(m)10-10-0.75L	25.8	25	746	254	286	544
50SWE(m)8-16-1.1L	33.6	31.7	749	289	368	354
50SWE(m)8-20-1.5L	43.2	38.4	924	284	363	294
50SWE(m)15-20-2.2L	44.9	46.3	924	284	363	294
50SWE15-25-3L	-	49.5	874	284	363	316



**Application**

- Drainage of wastewater from the attenuation tank, purifying tank and sewage tank in water treatment plant
- Drainage of waste water containing fibrous additives from leather factory and food processing factory
- Sewage management, accumulated water, septic tank, stock farm
- Pumping sewage form hotels, restaurants, schools and public buildings

**Pump**

- High-efficiency & anti-clogging enclosed channel impeller
- Flexible installations with hoses, pipes or quick-coupling systems
- Float switch as standard accessory for single phase (≤1.1 kw)
- Cable Length: 10m
- Double-end mechanical seal
- Stainless steel welded shaft
- Liquid temperature: 0 - 40 °C
- Liquid PH value: 4 - 10
- Max. immersion depth: 10 m

**Motor**

- Frequency/Pole number: 50 Hz/2
- Insulation class: F
- Enclosures class: IP68
- Bearing: Ball type

**Identification Codes**

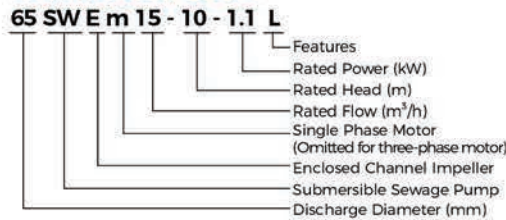

( Hose coupling as standard.  
Flange elbow is optional. )

**Technical Data**

Model		Discharge	Power		Rated flow	Max. flow	Rated head	Max. head	Max. Solid Dia
Single Phase	Three Phase	mm (inch)	kW	HP	m³/h	m³/h	m	m	mm
65SWE15-10-1.1L	65SWE15-10-1.1L	65 (2.5")	1.1	1.5	15	34	10	14	25
65SWE15-15-1.5L	65SWE15-15-1.5L	65 (2.5")	1.5	2	15	44	15	20	25
-	65SWE25-17-2.2L	65 (2.5")	2.2	3	25	40	17	24	25
-	65SWE25-22-3L	65 (2.5")	3	4	25	45	22	28.5	25
-	65SWE25-28-4L	65 (2.5")	4	5.5	25	50	28	31.5	25

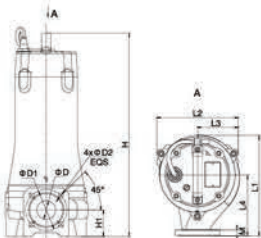

**Dimension**

Model	L1 (mm)	L2 (mm)	L3 (mm)	L4 (mm)	H(mm)		H1 (mm)	D (mm)	D1 (mm)	D2 (mm)	M (mm)
					1-	3-					
65SWE(m)15-10-1.1L	288	225	117	178	490	490	77.5	65	130	14	16
65SWE(m)15-15-1.5L	581				540						
65SWE25-17-2.2L	540				540						
65SWE25-22-3L	-				571						
65SWE25-28-4L	-				571						

**Hydraulic Performance Curves**

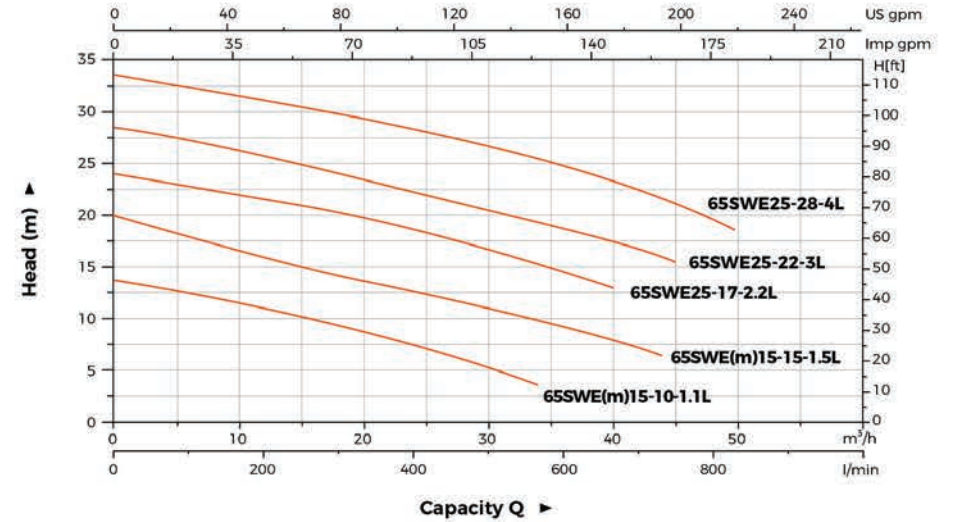

**Material Table**

No.	Part	Material
1	Handle	ZG45
2	Upper cover	HT200
3	Upper bearing seat	HT200
4	Motor body	HT200
5	Oil chamber	HT200
6	Pump cover	HT200
7	Pump body	HT200
8	Impeller	HT200
9	Oil seal	
10	Mechanical seal	Upper:SiC/Carbon Lower:SiC/SiC
11	Bearing	
12	Rotor	
13	Stator	

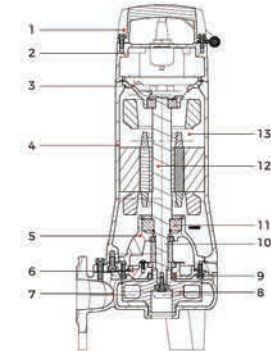

**Package Information**

Model	GW (kg)		L (mm)	W (mm)	H (mm)	Quantity (PCS/20'TEU)
	1-	3-				
65SWE(m)15-10-1.1L	37.9	35.8	749	289	368	354
65SWE(m)15-15-1.5L	45.7	41.9	924	284	363	294
65SWE25-17-2.2L	-	44.1	924	284	363	294
65SWE25-22-3L	-	52	874	284	363	316
65SWE25-28-4L	-	55.1	874	284	363	316



**Application**

- Drainage of wastewater from the attenuation tank, purifying tank and sewage tank in water treatment plant
- Drainage of waste water containing fibrous additives from leather factory and food processing factory
- Sewage management, accumulated water, septic tank, stock farm
- Pumping sewage form hotels, restaurants, schools and public buildings

**Pump**

- High-efficiency & anti-clogging enclosed channel impeller
- Flexible installations with hoses, pipes or quick-coupling systems
- Double-end mechanical seal
- Stainless steel welded shaft
- Liquid temperature: 0 - 40 °C
- Liquid PH value: 4 - 10
- Max. immersion depth: 10 m

**Motor**

- Frequency/Pole number: 50 Hz/2
- Insulation class: F
- Enclosures class: IP68
- Bearing: Ball type

**Identification Codes**

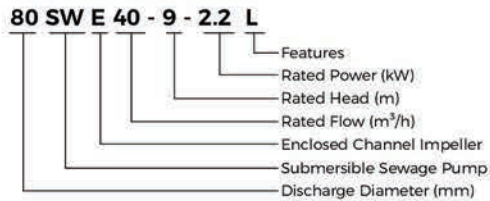

**Technical Data**

Model	Discharge	Power		Rated flow	Max. flow	Rated head	Max. head	Max. Solid Dia
	mm (inch)	kW	HP					
80SWE40-9-2.2L	80(3")	2.2	3	40	69.5	9	17	30
80SWE40-13-3L	80(3")	3	4	40	76	13	21	30
80SWE40-18-4L	80(3")	4	5.5	40	83	18	23	30

**Dimension**

Model	L1 (mm)	L2 (mm)	L3 (mm)	L4 (mm)	H (mm)	H1 (mm)	D (mm)	D1 (mm)	D2 (mm)	M (mm)
80SWE40-9-2.2L										
80SWE40-13-3L	265	223	112	160	557	86	80	150	18	16
80SWE40-18-4L										

**Hydraulic Performance Curves**

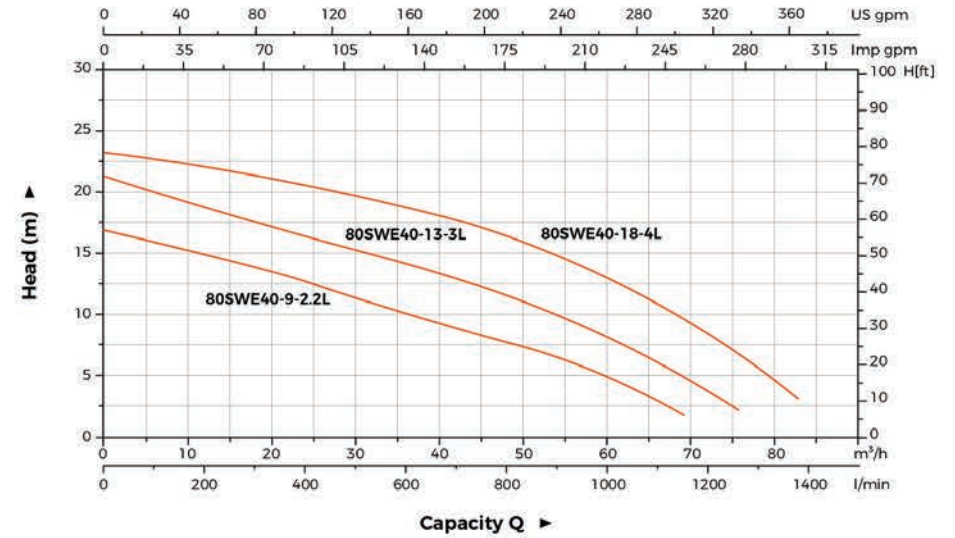

**Material Table**

No.	Part	Material
1	Handle	ZG45
2	Upper cover	HT200
3	Upper bearing seat	HT200
4	Motor body	HT200
5	Oil chamber	HT200
6	Pump cover	HT200
7	Pump body	HT200
8	Impeller	HT200
9	Oil seal	
10	Mechanical seal	Upper.Sic/Carbon Lower.Sic/Sic
11	Bearing	
12	Rotor	
13	Stator	

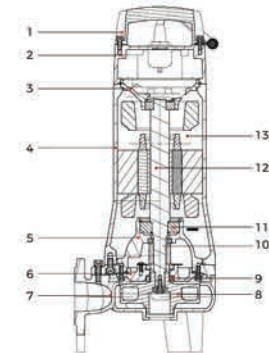

**Package Information**

Model	CW (kg)	L (mm)	W (mm)	H (mm)	Quantity (PCS/20'TEU)
80SWE40-9-2.2L	46.4	924	284	363	294
80SWE40-13-3L	53.8	874	284	363	316
80SWE40-18-4L	56.3	874	284	363	316